



**LITHIUM PET CLIPPER
INSTRUCTIONS**

LITHIUM PET CLIPPER

LITHIUM PET CLIPPER

Please read all instructions carefully to familiarise yourself with your rechargeable pet clipper before using.

Save these instructions for further reference.

For any further assistance or information call Customer Services on

T: 01227 740066

or visit

W: www.wahl.co.uk

E: customer.services@wahl.co.uk

CONTENTS

GENERAL USER INFORMATION	Page 4
IMPORTANT SAFEGUARDS	Page 5
OPERATING INSTRUCTIONS	Page 8
CLEANING AND MAINTENANCE	Page 16
TROUBLESHOOTING	Page 17
BATTERY REPLACEMENT, DISPOSAL AND WIRING	Page 18
GUARANTEE	Page 20

LITHIUM PET CLIPPER

GENERAL USER INFORMATION

Information about using the operation manual

- ▶ Before using the appliance for the first time, you must read and understand the operation manual completely.
- ▶ Consider the operation manual as part of the product and store it in a safe and accessible place.
- ▶ Include this operation manual if passing the appliance on to a third party.
- ▶ In the case of conflicts with national safety specifications or instructions, the national requirements must be followed.

Explanation of symbols and notes



DANGER

Danger of electric shock which may result in serious physical injury or death.



DANGER

Danger of explosion which may result in serious physical injury or death.



WARNING

Warning of possible physical injury or a health risk.



CAUTION

Information about danger of material damage.



Note with useful information and tips.

- ▶ Action to be taken by owner.
1. Carry out these actions in the sequence described.
- List

Please retain this leaflet for future reference.

READ ALL INSTRUCTIONS BEFORE USING.

IMPORTANT SAFEGUARDS

When using this electrical appliance, especially when children are present, basic safety precautions should always be observed including the following.

Requirements

- ▶ Read the instruction manual in full to familiarise yourself with the product before the first use.
- ▶ This appliance can be used by children from aged 14 years and above and persons with reduced physical, sensory or mental capabilities, or lack of experience and knowledge, if they have been given supervision or instruction concerning use of the appliance in a safe way and understand the hazards involved. Children shall not play with the appliance. Cleaning and user maintenance shall not be made by children without supervision.
- ▶ Use this appliance only for its intended purpose.

Hazards



Danger! Electric shock due to damage to appliance

- ▶ Do not operate the appliance with a broken cord, plug or charger, or if the appliance malfunctions, or is dropped or damaged in any way.
- ▶ Any servicing or repair must be performed by Wahl (UK) Ltd or a suitably qualified professional.
- ▶ The use of attachments that are not supplied by the manufacturer may cause fire, electric shock or injury and damage to the appliance.



Danger! Electric shock due to penetration of liquid.

- ▶ To protect against risk of electrical shock, never immerse the unit or let it come into contact with water or any other liquids. Do not use the unit with wet hands. If the appliance should become wet, damp or fall in water, remove plug from mains socket immediately. Do not put your hands in the water. Do not take into bathroom.



Danger of explosion

- ▶ Never use the appliance where aerosol (spray) products are being used or where oxygen is released.
- ▶ Exhausted batteries/rechargeable batteries/

Lithium batteries should not be disposed of in the household waste. Dispose of them in a completely discharged state in accordance with local legal regulations. Do not throw into fire where heat could cause them to rupture.



Warning! Injuries due to incorrect handling

- ▶ Switch off the appliance and unplug from outlet when not in use, before putting on or taking off attachments and also before cleaning the appliance.
- ▶ Never use your appliance without paying attention! Except when charging, always unplug this appliance from the electricity outlet immediately after using.



Caution! Danger of product damage

- ▶ Do not wrap the cord around the appliance / charger.
- ▶ Do not use outdoors or in damp areas.
- ▶ Never carry the unit by its power cord.
- ▶ Do not drop or insert any object into any opening.
- ▶ Use this appliance only for its intended purpose.
- ▶ During use, do not place or leave appliance where it may be damaged by an animal or exposed to weather.
- ▶ The blades on your clipper have fine teeth for precise cutting. Handle carefully when using against the animals skin to avoid injury or irritation.

LITHIUM PET CLIPPER

OPERATING INSTRUCTIONS

CHARGING THE BATTERY

Before the appliance is used for the first time, it should be charged for 2 hours, you will need to plug the transformer directly into the unit. Be sure the clipper is switched off. Whilst charging the power indicator light will be red, and turn green once fully charged, when the battery is fully charged the clipper can be used for up to 120 minutes .



CHARGING PRECAUTIONS

- Only charge the device when charging is required. A charge is required when the product begins to slow down or has trouble maintaining speed while performing its intended function. (Note: If the product is cord/cordless, and you do run out of charge, you may continue running the device corded from the mains to complete your task.)
- If the device is fully discharged, apply a charge right away to prevent damage or inability to recharge.

LITHIUM PET CLIPPER

- Charge the device at moderate temperatures.
Do not charge below freezing.
- Do not leave the device connected to the charger when the charger is not plugged into an outlet for charging.
- Perform regular maintenance on the device including keeping the blades oiled, clean, and free of debris to prevent taxing the battery.

FOR DIRECT PLUG-IN OPERATION

1. Should you need to use the appliance in corded mode when the battery is fully discharged, it is best to charge the appliance in OFF position for several minutes before use. During use, you may notice a change in blade speed. This is perfectly normal. The clipper will still perform adequately in corded mode with fully discharged batteries.
2. Connect the appliance to the transformer cord, and plug the wall transformer into an electrical outlet.
3. Move the switch to ON position.
4. After use, turn to OFF position then disconnect wall transformer from outlet.

BLADES

- Blades do not become dull from cutting hair, they are dulled by abrasive particles on the hair, such as dirt, sand and grease etc.
- Blades will not cut if abrasive particles are picked up and carried by the oil film between the blades. These particles tend to hold the blades apart and cause chewing and pulling of the hair instead of clean cutting.
- Oil blades before and during use. Oiling the blades performs two distinct functions.
 - a. Provides a low friction, very thin film lubricant between the cutting blades so that they can take a full cutting stroke without becoming hot from friction.
 - b. Flushes abrasive particles and hair out from between the blades.

LITHIUM PET CLIPPER

CLIPPER USE AND MAINTENANCE

- A fully charged appliance will deliver a maximum of 120 minutes of continuous trimming.
- To ensure maximum battery performance the appliance should be connected to the transformer and fully recharged after use. Once charged remove the appliance from the transformer and store in a cool, dry place. The transformer is designed to continuously charge the battery without overcharging.
- Use only the power source specified on the charger transformer.
- Feed the appliance gently through the hair allowing time for the blade to cut. Feeding too fast, wedges the hair between the blades, preventing them from cutting properly.
- It is acceptable for the unit to become somewhat warm during normal use.
- Avoid pushing the blades into the skin, taking extra care around sensitive areas or areas where folds of skin are present. The large flat surface of the blade should be parallel to the skin surface. Do not allow the sharp blade tips to go into the skin as this will cause injury.
- During clipping it may be necessary to clean and oil the blades. Place a small drop of Wahl Clipper Oil on the blades while the clipper is running.
- To prolong blade life, do not use the appliance on dirty or wet coats.
- Be careful not to drop the appliance or to damage or break any teeth on the blades. A new blade should be purchased if the teeth are damaged.
- Always oil the blades and replace the blade guard when the clipper is not in use.
- Keep the cord untwisted and unobstructed. When stored, the cord should be coiled and the unit placed in a dry place, away from children.

LITHIUM PET CLIPPER

- Do not store the appliance in a wet or moist environment.
- Do not touch any of the internal mechanisms. If the unit should need repair, do not repair it yourself. Return it to Wahl UK Ltd.

ATTACHMENTS

This appliance can be operated with attachment combs. Attachment combs can be used to extend the cutting length range. To attach the combs, hold comb with teeth up and snap it firmly to the bottom of the clipper blade. For uniform cutting, allow the clipper to cut its way through the hair. Do not force it through at a faster rate.

DESIRED LENGTH	ATTACHMENT	DIRECTION OF CUT
0.8mm-3.2mm	none	against the grain
1.6mm-4.7mm	none	with the grain
3mm	comb #1	against the grain
6mm	comb #2	against the grain
9mm	comb #3	against the grain
12mm	comb #4	against the grain

Chart1.1

USING AN ATTACHMENT COMB

Attaching your clipper combs is easy (Fig.6) Hold the comb with the teeth facing upwards. Snap the comb attachment firmly to the bottom of the clipper blade until the tab is firmly gripped.

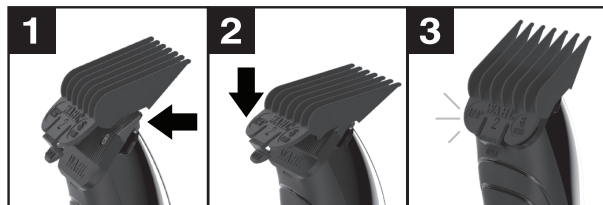

LITHIUM PET CLIPPER

HOW TO OPERATE YOUR NEW WAHL PET CLIPPER

BEFORE YOU CUT

Tip: Make sure your clipper is clean, oiled and in perfect working condition before you start.

Tip: A clean and well brushed coat will ensure better results and a happier pet.

1. Comb through the coat to remove any tangles, and then bathe your animal in lukewarm water to remove any dirt. Bathing your dog beforehand will make clipping easier.
2. We recommend the use of shampoo/conditioner from the Wahl Shampoo range prior to cutting. There are shampoos available for all types and colours of hair. Please visit www.wahl.co.uk for more information.
3. Rinse well and allow the coat to dry completely.
4. Brush hair thoroughly after bathing. Comb out any additional tangles to make clipping and trimming as easy as possible. This is very important to prevent snags. When using the comb attachments, if the coat is not clean, dry and tangle free the combs will not remain on the clipper blades.

CLIPPING TIPS FOR ALL BREEDS OF DOGS

Before clipping your dog for the first time, switch on the clipper for a short time near the animal so it gets used to the noise. If clipping for the first time, the clipping process will be slow. Try to move with the dog when clipping. After a few grooming sessions, you will develop your own comfortable style and grooming will get faster. Take your time and use lots of encouragement and affection. Dogs know when you are in a hurry and will get nervous, making grooming more difficult.

LITHIUM PET CLIPPER

CLIPPING & TRIMMING DOGS

The first time you cut hair, cut only a small amount until you have become accustomed to how long each guide comb leaves the hair. Ensure that you regularly remove trimmed hair from the blades, clean and oil the blades during clipping.

CLIPPING GUIDE GENERAL - FEET

IT IS IMPORTANT TO TRIM OUT EXCESS HAIR ON PADS, OTHERWISE THE PADS WILL BECOME DIRTY AND MATTED CAUSING PAINFUL WALKING.

Have your dog sit facing you. Bring rear leg forward carefully, (Fig.7) and clip sides of foot from nail to ends of toes.

Clip on top of toes, stopping at ankle joint. Don't trim ankle. Spread toes apart with thumb and finger (Fig.8). Cut hair between toes, being careful not to nick the webbing. A trimmer with a smaller blade may be easier in this sensitive area.

Spread bottom pads with thumb and clip between toes and pads, being careful not to nick foot webbing (Fig.9). Touch up stray hair with scissors.

FACE AND THROAT

Be very careful around this area, clipping too close may cause razor burns. You should use the clippers in the same direction as the lie of the coat. The clipper must not be used above or around the eyes. When clipping ears lift them to ensure no creases or folds of skin are on the area to be clipped (Fig.10). Hold muzzle with your free hand. Cut from ear to the outside corner of the eye in a straight line. Stretch the skin at the outside corner of the left eye upward and backward. Clip carefully under eye. Repeat on other side. With free hand, stretch the corner of the mouth with your thumb, using the rest of your hand to hold the mouth shut. Clip around mouth and side of face. Repeat on other side.

LITHIUM PET CLIPPER

Holding the muzzle, clip the area between the eyes and down the nose. To clip the muzzle, clip away from the eyes toward the nose. Hold the dogs head straight, throat taught, and clip bottom of muzzle (Fig.13) the Adam's apple is normally the stopping point of the cut but you may clip lower. Clip the rest of the throat toward the muzzle.

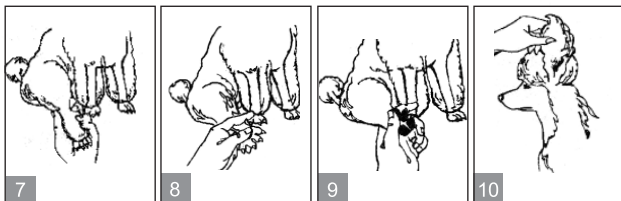

STOMACH

Stand dog facing you. Lift front legs and clip from a point above the testicles or vulva in a straight line, use light pressure being careful not to nick the vulva, penis, testicles or nipples. Cover them with your hand. Clip the hair on penis with the grain.

BODY

Tip: Stop frequently while clipping to fluff the hair. It will help keep the hair even. Clip along the back, starting at the base of the skull, and cut down the middle of the back to the tail (Fig.14). Shorten all the hair as shown in the illustration, starting at the neck (Fig.15) clip hair between shoulders and hips. Clip under the chest from behind the front legs to the end of the rib cage. Scissor trim to touch up.

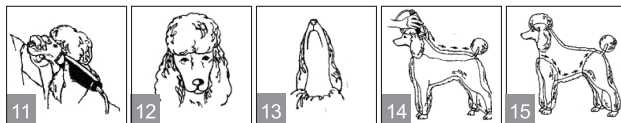

LITHIUM PET CLIPPER

REAR LEGS

Important: Be careful when clipping around the armpit and the flank. There are areas of skin that are easy to cut; especially on older dogs whose skin has loosened. Brush the hair in the back of the legs in an upward and outward motion, to fluff. You can now shape the legs as full or as tapered as you wish. Start by trimming any hair that falls over the foot (Fig.16). Starting at the ankle, cut up to the hip a little hair at a time (Fig.17). Once you are at the hip, blend hair so it tapers into shorter body hair. (When using guide combs on legs, complete your stroke; don't stop midway.) Repeat with other leg, making it the same size as the first leg. Touch up with scissors.

FRONT LEGS

With the dog facing you, comb hair up and out. Trim front legs to match the back legs. Comb hair at shoulders and blend with shorter body hair. Comb hair on chest and between front legs; Trim it to the length of the shoulder and body hair.

EARS

With the dog facing you, clip from the top of the ear downward. Never turn the clipper in the other direction. Lay the ear in the palm of your hand. Clip the outside of the ear first and then the inside (Fig.19). Hold ear with your free hand and scissor cut the sides. Be careful not to cut the ear itself (Fig.20). Repeat with the other ear and touch up any stray hairs.

Clipping is generally done "With the Grain" or natural fall of the hair on the body and legs. Clipping "Against the Grain" will give approximately a 50% closer cut and this method is often used when clipping the face and throat, feet and tail.

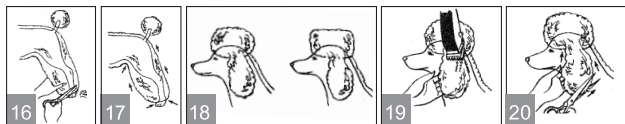

LITHIUM PET CLIPPER

CLEANING AND MAINTENANCE

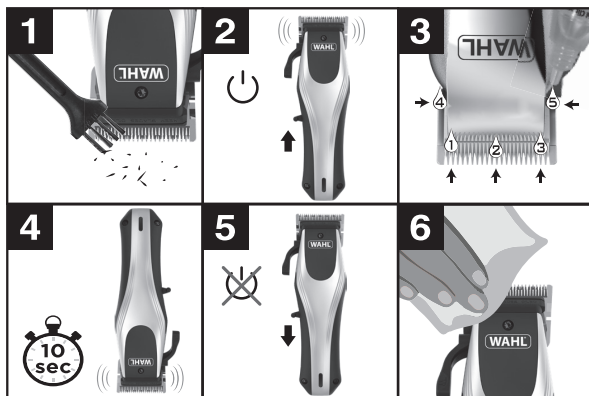

Always disconnect the appliance from the wall socket before any cleaning operation.

- To clean the unit, use either a clean dry or dampened cloth. Do not use abrasive cleaning agents or scrub pads. Do not use alcohol or solvents.
- To remove hair from between the blades, use the cleaning brush provided.
- Never immerse the clipper in water or any other liquid.
- After each use, blades should be cleaned and oiled. Put a small drop of Wahl Clipper Oil between the blades while the trimmer is running. Wipe off excess oil so it does not run into the motor.

TROUBLESHOOTING

If your clipper does not seem to take a charge, check the following before returning it for repair:

- Check outlet to make sure it is working by plugging in another appliance.
- Be sure the clipper is properly connected to the recharging transformer, all connections are secure and the switch on the clipper is turned OFF.
- If your electricity is connected to a master power switch, we suggest the clipper be disconnected from the charger anytime the master switch is off. Leaving the unit plugged into a dead outlet or an unplugged charger will drain the battery.
- If the clipper does not run and is completely charged, turn the unit ON and pinch or push the blades manually. (Oil may have dried out between the blades, so they may be temporarily stuck together.)

LITHIUM-ION BATTERY REPLACEMENT



For battery replacement the entire, intact clipper or trimmer should be sent to: Wahl (UK) Ltd Customer Services (the address can be found on the reverse of this booklet) or taken to a suitably qualified professional. The battery should only be replaced by the original manufacturers spare, for safety reasons a substitute should not be used. Do not attempt to remove the battery. Lithium-Ion batteries can explode, catch fire, and/or cause burns if disassembled, damaged or exposed to water or high temperatures.

LITHIUM PET CLIPPER

LITHIUM BATTERY DISPOSAL



Do not dispose of this product or the Lithium battery in the normal household waste.

The product should be returned to Wahl Customer Services where we offer a take back service or taken to a local collection facility where they will be dealt with safely and sent for the appropriate recycling

WIRING



WARNING: IF THE TRANSFORMER IS DAMAGED IT MUST BE REPLACED IN ORDER TO AVOID A HAZARD.



WARNING: THIS PRODUCT MUST ONLY BE USED WITH THE TRANSFORMER SUPPLIED. SHOULD A REPLACEMENT BE REQUIRED CONTACT WAHL CUSTOMER SERVICE ON 01227 740066.



DISPOSAL

Handle with care! Environmental damage in the case of incorrect disposal.

Correct disposal will ensure environmental protection and prevent any potentially harmful impacts on people and the environment.

Adhere to the relevant legal requirements when disposing of the appliance. Information on the disposal of electrical and electronic appliances in the European Community:

**WASTE ELECTRICAL & ELECTRONIC EQUIPMENT
DIRECTIVE 2012/19/EU (WEEE)**



At the end of this products life it should not be disposed of with general household waste.

Care should be taken to dispose of in a suitable manner in accordance with your Local Authority regulation.



LITHIUM PET CLIPPER

GUARANTEE

This product is guaranteed against defects in material and workmanship for a period of 2 years from the date of original purchase or receipt as a gift.

Should this product become defective during the guarantee period, return it to the store of purchase together with your proof of purchase for repair or replacement.

Alternatively within the guarantee period you can return the product to Wahl (UK) Ltd who will repair any such defect or elect to replace the product or any part of it, without charge, provided that there is proof of purchase. Should a replacement be offered this will not extend the original guarantee period.

The guarantee becomes invalid in the case of misuse, alteration or repair by unauthorised persons.

This guarantee does not include blades, cables, shaver heads, foils and cutters etc which are consumable parts.

This product is designed for domestic use only and use within a professional environment will invalidate the guarantee.

This guarantee in no way affects your rights under statutory law in the United Kingdom.

LITHIUM PET CLIPPER

WAHL (UK) LTD
STERLING HOUSE
CLIPPER CLOSE
RAMSGATE, KENT
CT12 5GG

CUSTOMER SERVICES T: 01227 740066
www.wahl.co.uk

Form No. 1007788
Rev.0 06-22