



PROFESSIONAL

# Cordless Trimmer Instructions

## Cordless Trimmer instructions

## Cordless Trimmer instructions

Please read all instructions carefully to familiarise yourself with your new Wahl Cordless Trimmer before using.

Save these instructions for further reference.

For any further assistance or information call Customer Services on

T: 01227 740066

or visit

W: [www.wahl.co.uk](http://www.wahl.co.uk)

E: [customer.services@wahl.co.uk](mailto:customer.services@wahl.co.uk)

### CONTENTS

<b>GENERAL USER INFORMATION</b>	Page 4
<b>IMPORTANT SAFEGUARDS</b>	Page 5
<b>DESCRIPTION OF PARTS 8171</b>	Page 8
<b>OPERATING INSTRUCTIONS 8171</b>	Page 9
<b>DESCRIPTION OF PARTS 8163</b>	Page 12
<b>OPERATING INSTRUCTIONS 8163</b>	Page 13
<b>CLEANING AND MAINTENANCE</b>	Page 16
<b>BATTERY REPLACEMENT, REMOVAL &amp; DISPOSAL</b>	Page 17
<b>TROUBLESHOOTING</b>	Page 17
<b>WIRING</b>	Page 18
<b>GUARANTEE</b>	Page 19

## GENERAL USER INFORMATION

Information about using the operation manual

- ▶ Before using the appliance for the first time, you must read and understand the operation manual completely.
- ▶ Consider the operation manual as part of the product and store it in a safe and accessible place.
- ▶ Include this operation manual if passing the appliance on to a third party.
- ▶ In the case of conflicts with national safety specifications or instructions, the national requirements must be followed.

### Explanation of symbols and notes



**DANGER**

Danger of electric shock which may result in serious physical injury or death.



**DANGER**

Danger of explosion which may result in serious physical injury or death.



**WARNING**

Warning of possible physical injury or a health risk.



**CAUTION**

Information about danger of material damage.



Note with useful information and tips.

- ▶ Action to be taken by owner.
1. Carry out these actions in the sequence described.
- List

Please retain this leaflet for future reference.

READ ALL INSTRUCTIONS BEFORE USING.

## **IMPORTANT SAFEGUARDS**

When using this electrical appliance, especially when children are present, basic safety precautions should always be observed including the following.

### **Requirements**

- ▶ This appliance can be used by children from aged 14 years and above and persons with reduced physical, sensory or mental capabilities, or lack of experience and knowledge, if they have been given supervision or instruction concerning use of the appliance in a safe way and understand the hazards involved. Children shall not play with the appliance. Cleaning and user maintenance shall not be made by children without supervision.
- ▶ Use this appliance only for its intended purpose.

## Hazards



### **Danger: Electric shock due to damage to appliance**

- ▶ Do not operate the appliance with a broken cord, plug or charger, or if the appliance malfunctions, or is dropped or damaged in anyway.
- ▶ Any servicing or repair must be performed by Wahl (UK) Ltd. or a suitably qualified professional.
- ▶ The use of attachments that are not supplied by the manufacturer may cause fire, electric shock or injury and damage to the appliance.



### **Danger: Electric shock due to penetration of liquid.**

- ▶ To protect against risk of electrical shock, never immerse the unit or let it come into contact with water or any other liquids. Do not use the unit with wet hands. If the appliance should become wet, damp or fall in water, remove plug from mains socket immediately. Do not put your hands in the water. Do not take into bathroom.



**Danger of explosion**

- ▶ Never use the appliance where aerosol (spray) products are being used or where oxygen is released.
- ▶ Exhausted batteries/ rechargeable batteries should not be disposed of in the household waste. Dispose of them in a completely discharged state in accordance with local legal regulations. Do not throw into fire where heat could cause them to rupture.



**Warning: Injuries due to incorrect handling**

- ▶ Switch off the appliance and unplug from outlet when not in use, before putting on or taking off attachments and also before cleaning the appliance.
- ▶ Never use your appliance without paying attention! Except when charging always unplug this appliance from the electricity outlet immediately after using.



**Caution: Danger of product damage**

- ▶ Do not wrap the cord around the appliance / charger.
- ▶ Do not use outdoors or in damp areas.
- ▶ Never carry the unit by its power cord.
- ▶ Do not drop or insert any object into any opening.

## Cordless Trimmer instructions

**Model: 8171**



### DESCRIPTION OF PARTS

- A. Blade
- B. "ON - I"/"OFF - 0" switch
- C. Blade guard
- D. Attachment comb 1
- E. Attachment comb 2
- F. Attachment comb 3
- G. Blade Oil
- H. Cleaning Brush

- I. Beard brush
- J. Charging Stand
- K. Transformer
- L. Flattop comb



## OPERATING INSTRUCTIONS

### USING RECHARGEABLE CORD/CORDLESS TRIMMER

If battery power is low, the transformer can attach directly to the unit for continued use as a corded unit.



- Plug power cord into an outlet at the correct voltage.
- **CONNECT TRANSFORMER PLUG INTO RECEPTACLE IN BACK OF STAND** and place appliance in stand so nameplate faces forward (Fig.1). (Not all units have recharge stands. To recharge these units, plug power cord directly into unit.) Be sure appliance is switched "OFF - 0" when charging.
- **FOR CORDED OPERATION**, disconnect transformer from back of stand and connect to receptacle on the bottom of the unit. If your battery is completely run down, allow the unit to charge for 1 minute (switched "OFF - 0") before using as a corded unit.
- If the cord is left attached to the unit when not in use, the cord will automatically charge the unit when left in the "OFF - 0" position.  
**DO NOT USE BLEACH, BENZENE OR THINNER TO CLEAN THE UNIT.**

## Cordless Trimmer instructions

### REPLACING/ADJUSTING THE BLADE SET

Top Blade (Fig.2 a), Bottom Blade (Fig.2 b)

- Unscrew the blade and remove from the trimmer (Fig.3).
- Loosen the screws on the back of the top blade, but do NOT remove them (Fig.4).
- Slide the top blade forward so that the teeth are level with the teeth on the bottom blade, then pull the top blade back 0.25mm. Hold the top blade in position and tighten the screws (Fig.5).
- If you require zero overlap, the top and bottom blade should be flush. The top blade should NEVER overlap the bottom blade as

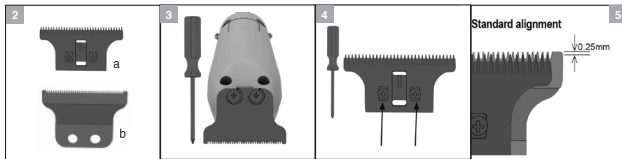

this can cause skin abrasions. Hold the top blade in position and tighten the screws (Fig.6).

- Slide the top blade off, there is no need to undo the screws (Fig.7).
- Oil the bottom blade then slide the top blade back into position (Fig.8).
- Attach the blade to your trimmer. (Fig. 9).

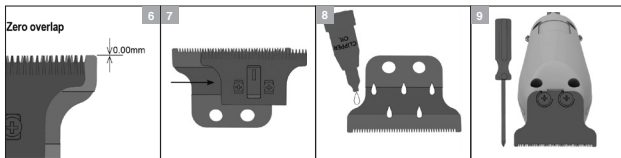

**CAUTION:** ENSURE THAT THE TEETH ON THE TOP BLADE DO NOT OVERLAP THE BOTTOM BLADE, THIS CAN CAUSE SKIN ABRASIONS.

### CHARGING THE BATTERY

Before the equipment is used for the first time, it should be charged 45 minutes to an hour. Recommendation: the batteries should only be recharged when the performance of the equipment has deteriorated noticeably.

DO NOT RUN appliance corded with a fully charged battery.

### QUICK CHARGE

For a one minute charge: Average use is 4 minute run time.

For a five minute charge: Average use is 14 minute run time.

### BATTERY OPERATION

Switch "ON - I" the equipment using the "ON - I"/"OFF - 0" switch and, after use, switch it "OFF - 0" again. When the battery is fully charged, the equipment can be used for up to 100 minutes of continuous run.

### LED INDICATOR

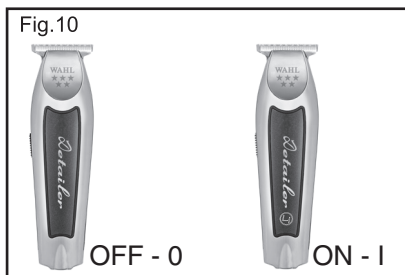

- Fully Lit: LED will be fully lit in use or when it has reached full charge (Fig.2).
- Flashing: Appliance has approximately 20% charge remaining.
- Pulse: While charging, the LED will pulse until battery is fully charged. The LED will change to solid when the appliance has a full charge.

## Cordless Trimmer instructions

**Model: 8163**



### DESCRIPTION OF PARTS

- |    |                   |    |                |
|----|-------------------|----|----------------|
| A. | Blades            | I. | Blade guard    |
| B. | Taper lever       | J. | Transformer    |
| C. | Charge indicator  | K. | Blade oil      |
| D. | Beard brush       | L. | Cleaning brush |
| E. | Flat top comb     | M. | Charging stand |
| F. | Attachment comb 1 |    |                |
| G. | Attachment comb 2 |    |                |
| H. | Attachment comb 3 |    |                |

### **USING RECHARGEABLE TRIMMERS**

- Plug Recharging cord into any convenient electrical outlet at the correct voltage.
- For initial charging time for trimmer refer to the charging battery section in this booklet.
- Trimmer blades have very precise hardened, ground, and lapped cutting teeth. Blades should be handled carefully and never bumped or used to cut dirty or abrasive materials.
- To clean the unit, use either a clean, dry or dampened cloth. **DO NOT USE** benzene or thinner to clean the unit.

### **TAPER LEVER**

This trimmer is equipped with an adjustable taper lever that changes the closeness of your cut. When the lever is in the uppermost position, the blades will give the closest cut. Pushing the lever downward gradually increases the cutting length.

### **DETACHABLE BLADE REMOVAL AND INSTALLATION**

To remove the blades, hold the unit firmly in your hand and push the blades away from the front of the trimmer. The blades and mounting plate behind them will all come off in one piece.

Use the cleaning brush provided to clean away any hair that has become clogged between the blades. Oil the blades after cleaning. (Please see Oiling Caution.)

To replace blades, place the tab at the bottom of the blade unit into the space provided on the unit. Once it is seated, snap blade into place. You will hear a click when the blades are fully in place.

### **BATTERY OPERATION**

- Switch the equipment on using the on/off switch and, after use, switch it off again.
- With the battery fully charged, the equipment can be operated for up to 60 minutes. This capacity is attained after approx. 5 charging cycles.
- To prolong the life of your unit, you should completely discharge the battery at least once a month by leaving the unit off the cord between uses and running it until it stops.

## Cordless Trimmer instructions

### **CHARGING THE BATTERY**

Before the equipment is used for the first time, it should be charged 1-2 hours. Connect power cord plug into receptacle in back of stand and place trimmer in stand so nameplate faces forward. (Not all units have recharge stands. To recharge these units, plug power cord directly into unit.)

Be sure the trimmer is switched OFF when charging. During charging, the charge indicator is illuminated. The charge indicator will shut off when fully charged.

Recommendation: the batteries should only be recharged when the performance of the equipment has deteriorated noticeably.

Note: If the unit is fully charged and is placed in the stand to charge, the LED may not turn on. This does not indicate the unit can no longer charge. It means the unit does not need to draw electricity because it is already fully charged.

**Models: 8171 & 8163**

**CORD CARE**

The cord should never be used to pull the trimmer. Freedom of movement needs to be maintained. Care should be used to keep the cord untwisted, and undamaged.

When stored, the cord should be coiled and placed neatly in a dry place.

**TRIMMING WITH ATTACHMENT COMBS**

Your trimmer includes three attachments, stubble, medium and long. The stubble guide has 1 bar, the medium-cut has 2 bars and the long attachment has 3 bars. These attachments are ideal for blending, tapering and defining beards, as well as for achieving a close trim stubble look around the face.

## CLEANING AND MAINTENANCE

### Blade care

Trimmer blades have precision-hardened, ground and lapped cutting teeth. Blades should be handled carefully and never bumped or used to cut dirty abrasive material. Should blades become dull or damaged, you may purchase a new blade assembly from Wahl.

### Oiling trimmer blades

The blades of your new trimmer should be oiled after every haircut. Simply place a few drops of Wahl Clipper Oil on the blades at points A and B. Switch the clipper on briefly (approx

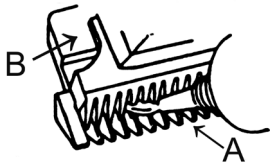

10 seconds) to ensure the oil film is evenly distributed. Use only the Wahl Clipper Oil included in the pack. Due to the high speed of your product, the correct type of oil must be used. Do not use hair oil, grease or any oil mixed with kerosene or any solvent, as the solvent will evaporate and leave the thick oil, slowing down the blades. Wahl Clipper Oil is a very thin, natural oil which will not evaporate and will not slow down the blades.

**!** **IMPORTANT:** Do not over oil.



### **Lithium Battery Replacement, Removal and Disposal**

#### **Lithium-Ion Battery Replacement**

For battery replacement the entire, intact clipper or trimmer should be sent to: Wahl (UK) Ltd Customer Services (the address can be found on the reverse of this booklet) or taken to a suitably qualified professional. The battery should only be replaced by the original manufacturers spare, for safety reasons a substitute should not be used.

Do not attempt to remove the battery. Lithium-Ion batteries can explode, catch fire, and/or cause burns if disassembled, damaged or exposed to water or high temperatures.

#### **Lithium Battery Disposal**

Do not dispose of this product or the Lithium battery in the normal household waste.

The product should be returned to Wahl Customer Services where we offer a take back service or taken to a local collection facility where they will be dealt with safely and sent for the appropriate recycling.

### **TROUBLESHOOTING**

If your trimmer does not seem to be charging, check the following before returning for repair.

1. Check outlet current by plugging in another appliance.
2. Be sure the trimmer is properly connected to the recharging transformer, all connections are secure and the switch on the trimmer is OFF.
3. If your electricity is connected to a master power switch, we suggest the trimmer be disconnected from the charger anytime the master switch is off. Leaving the unit unplugged into a dead outlet or an unplugged charger may drain the battery.
4. If the trimmer does not run and its completely charged, turn the unit ON and pinch or push the blades manually. (Oil may have dried out between the blades, so they may be temporarily stuck together).

## Cordless Trimmer instructions

### WIRING



**WARNING:** If the transformer is damaged it must be replaced to avoid a hazard.

This product must only be used with the transformer supplied, Should a replacement be required contact Wahl customer services.

### DISPOSAL



**Handle with care. Environmental damage in the case of incorrect disposal.**

Correct disposal will ensure environmental protection and prevent any potentially harmful impacts on people and the environment.

Adhere to the relevant legal requirements when disposing of the appliance.

**Information on the disposal of electrical and electronic appliances in the European Community:**

### WASTE ELECTRICAL & ELECTRONIC EQUIPMENT DIRECTIVE 2002/96/EC (WEEE)



Within the European Community, national regulations are specified for the disposal of electrical appliances, based on EU Waste Electrical and Electronic Equipment Directive 2002/96/EC (WEEE). In accordance with this, the appliance can no longer be disposed of with the local or domestic waste.

The appliance will be accepted free of charge by local collection points or recycling centres.

## **GUARANTEE**

This product is guaranteed against defects in material and workmanship for a period of one year from the date of original purchase or receipt as a gift.

Should this product become defective during the guarantee period, return it to the store of purchase together with your proof of purchase for repair or replacement.

Alternatively within the guarantee period you can return the product to Wahl (UK) Ltd who will repair any such defect or elect to replace the product or any part of it, without charge, provided there is proof of purchase. Should a replacement be offered this will not extend the original guarantee period.

The guarantee becomes invalid in the case of misuse, alteration or repair by unauthorised persons.

This guarantee does not include blades, cables, shaver heads, foils and cutters etc., which are consumable parts.

This guarantee in no way affects your rights under law in the United Kingdom.

WAHL (UK) LTD  
STERLING HOUSE  
CLIPPER CLOSE  
RAMSGATE, KENT  
CT12 5GG

CUSTOMER SERVICES T: 01227 740066  
[www.wahl.co.uk](http://www.wahl.co.uk)

Form No. ZB931  
Rev.0 08-19